



NOTES

CDM NOTE
 These drawings have been produced with reference to the CDM Regulations 2015. Please note that these are pre-construction phase drawings and should be subject to further design risk management as required in accordance with Regulation 9

KEY	
	Existing carriageway
	Proposed carriageway
	Existing footway
	Proposed Footway
	Existing 2-way cycleway
	Proposed 2-way cycleway
	Hard verge surface
	Proposed ramp

REV	DATE	REVISION NOTE	BY
PI	11.02.21	Cycleway/footway crossing amended to remove offset from main carriageway	NS

PJA
 CLIENT
Lidl Great Britain Ltd.
 PROJECT
 Lidl
 Holyhead Road
 Coventry
 DRAWING TITLE
**Proposed Access
 General Arrangement**

INFORMATION
 DRAWING ISSUE STATUS
 PJA JOB No. SUB-CODE DRAWING NO. REVISION
05003 - Ci - SK001 - PI
 Revision Letter: P - Prelim / A - Approval / T - Tender / C - Construction
 BIM/DRAWING REFERENCE

SCALE	DRAWN	REVIEWED	DATE
A3@1:250	NS	RMB	Feb. 21

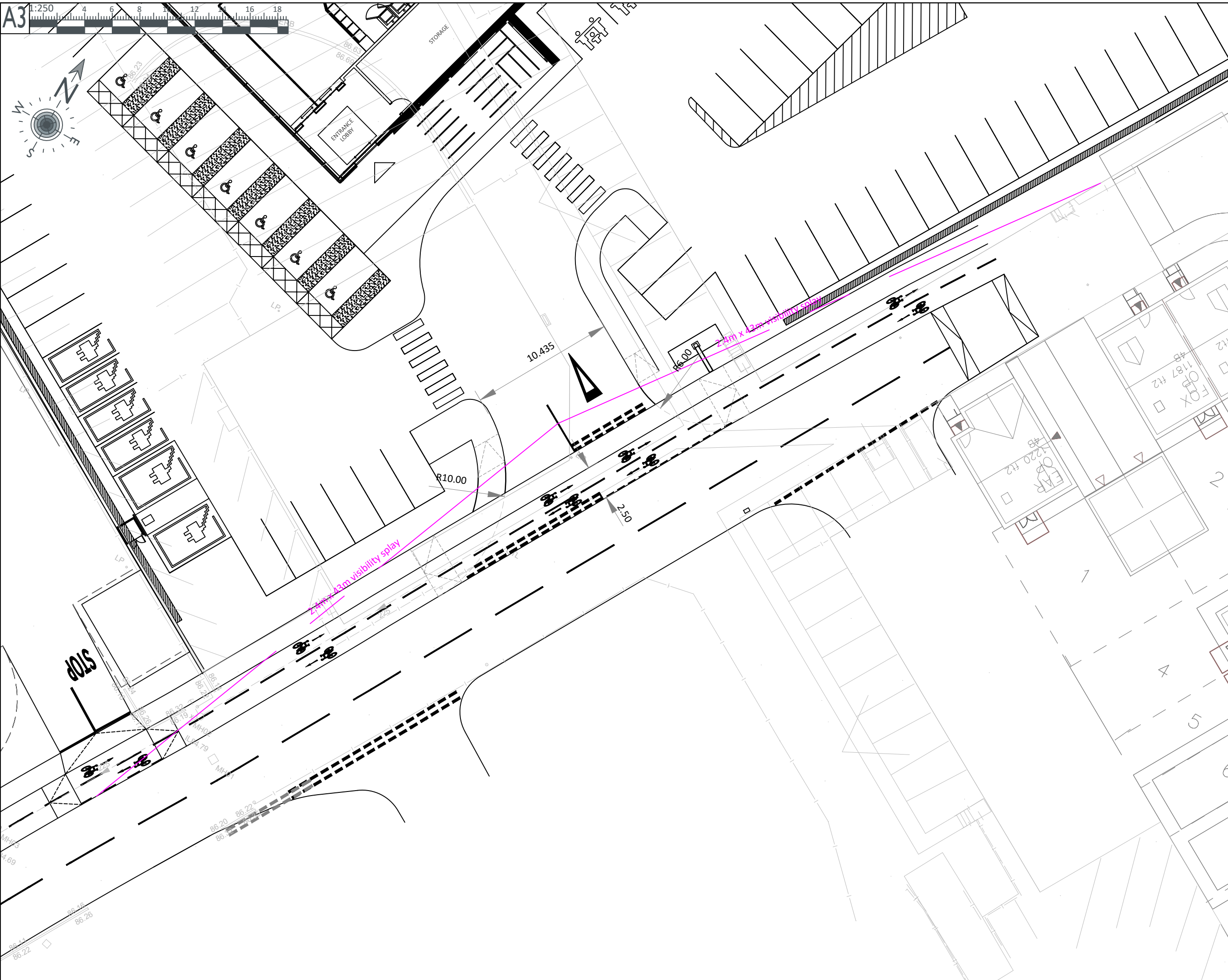
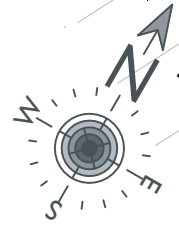

NOTES

CDM NOTE
 These drawings have been produced with reference to the CDM Regulations 2015. Please note that these are pre-construction phase drawings and should be subject to further design risk management as required in accordance with Regulation 9

REV	DATE	REVISION NOTE	BY
PI	11.02.21	Cycleway/footway crossing amended to remove offset from main carriageway	NS

PJA
 CLIENT
 Seven House - High Street
 Longbridge - Birmingham
 B31 2UQ - Tel: 0121 475 0234
 Birmingham - Bristol
 Exeter - London - Reading
 pja.co.uk

Lidl Great Britain Ltd.
 PROJECT

Lidl
 Holyhead Road
 Coventry

DRAWING TITLE
 Proposed Access
 Visibility Splays

INFORMATION

PJA JOB No. SUB-CODE DRAWING NO. REVISION
 05003 - Ci - SK002 - PI

Revision Letter: P - Prelim / A - Approval / T - Tender / C - Construction
 BIM/DRAWING REFERENCE

SCALE	DRAWN	REVIEWED	DATE
A3@1:250	NS	RMB	Feb. 21